

2022-07-29

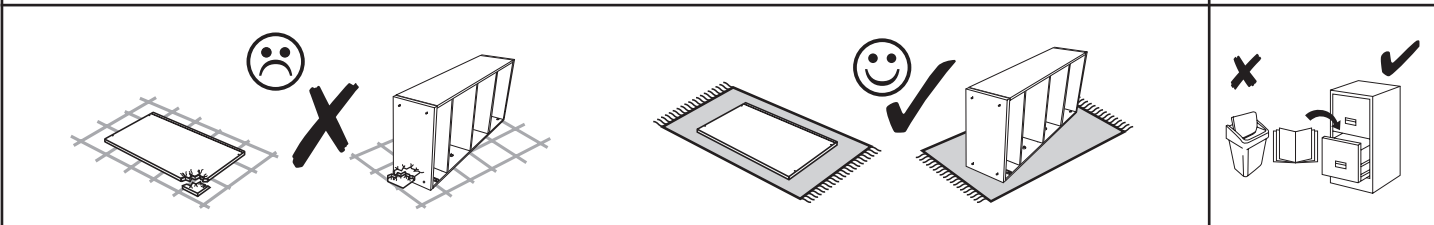

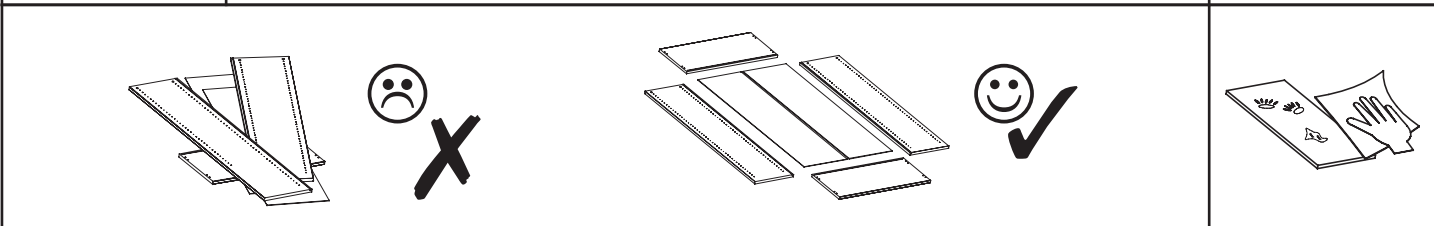

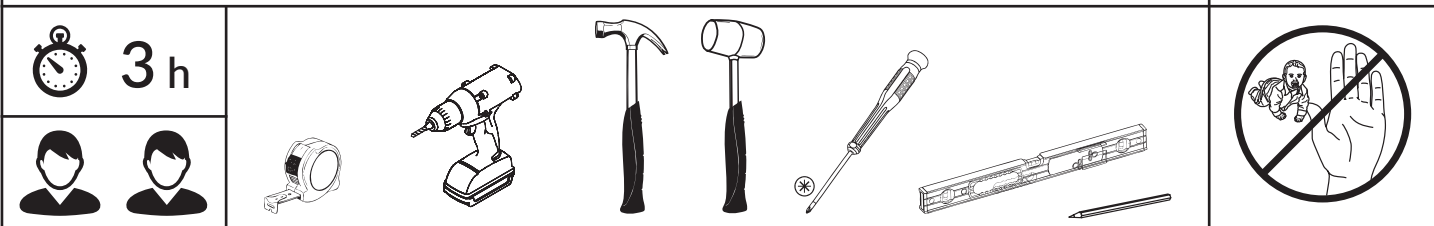
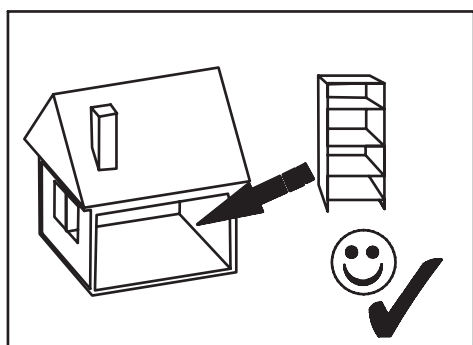
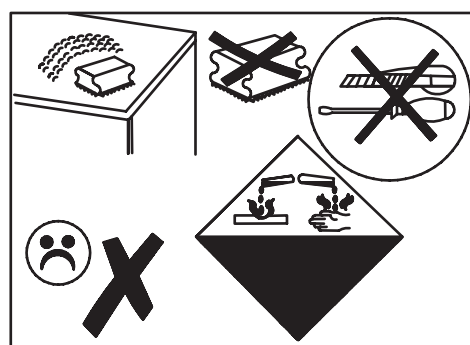
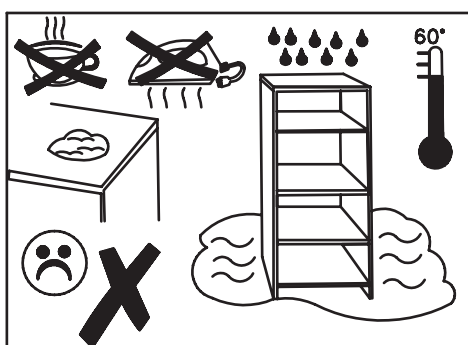
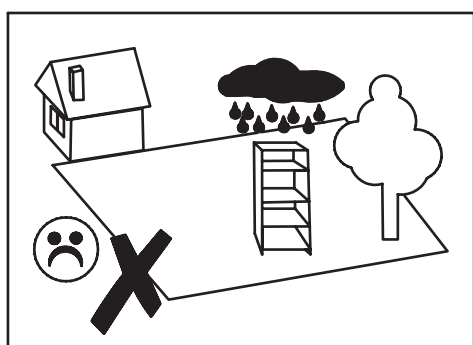
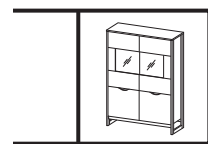
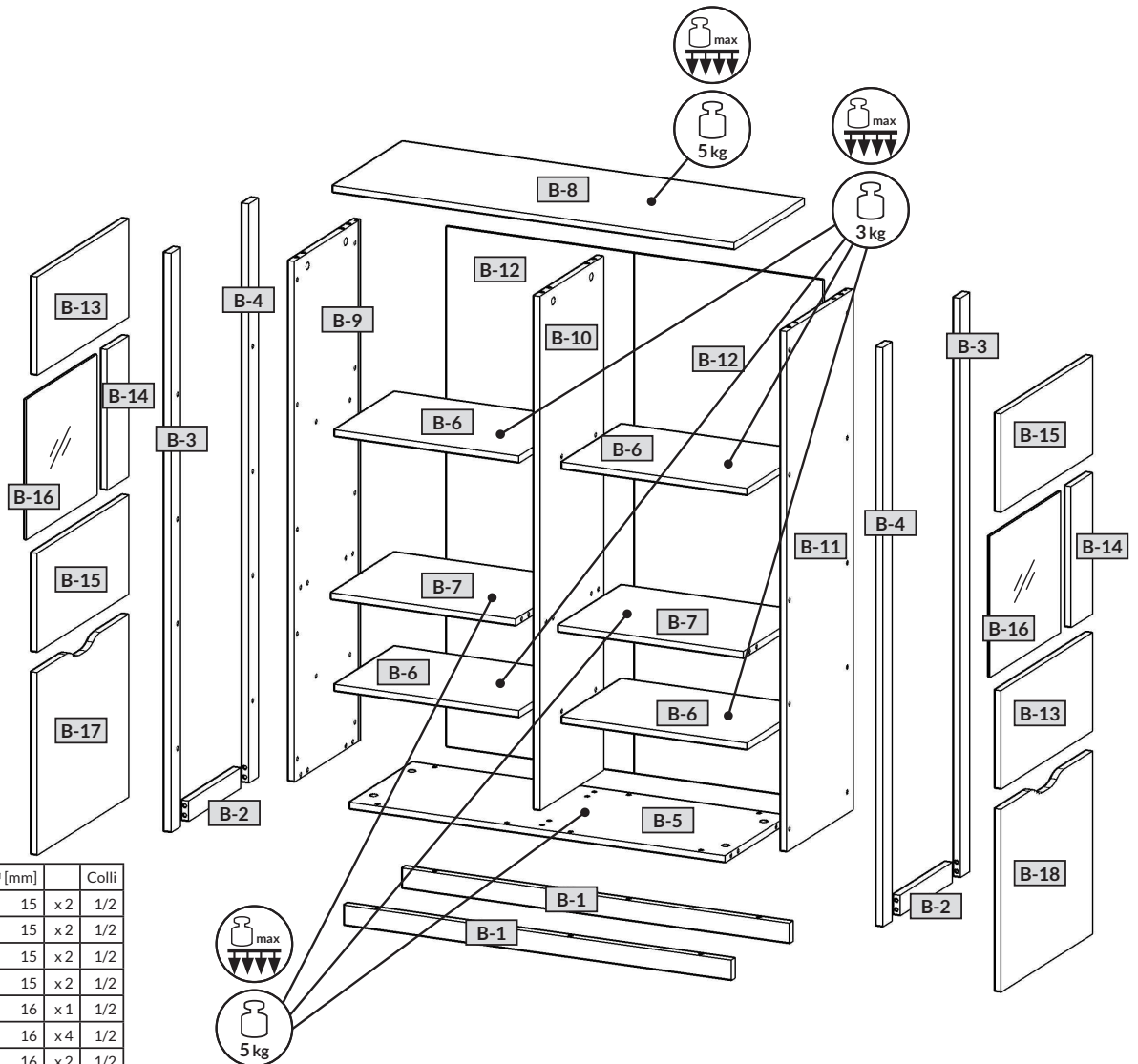
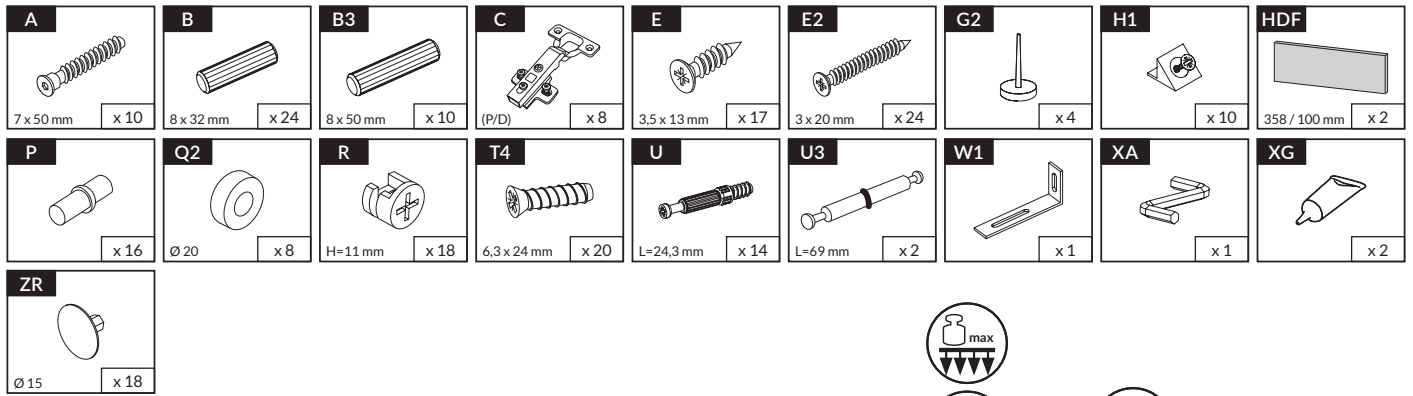
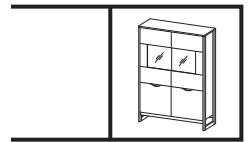

nr	↔ [mm]	↑ [mm]	∅ [mm]	Colli
B-1	1048	50	15 x 2	1/2
B-2	294	50	15 x 2	1/2
B-3	1480	50	15 x 2	1/2
B-4	1480	50	15 x 2	1/2
B-5	1016	359	16 x 1	1/2
B-6	500	340	16 x 4	1/2
B-7	500	359	16 x 2	1/2
B-8	1086	396	16 x 1	1/2
B-9	1330	374	16 x 1	1/2
B-10	1314	359	16 x 1	1/2
B-11	1330	374	16 x 1	1/2
B-12	1337	515	3 x 2	1/2
B-13	520	250	16 x 2	2/2
B-14	120	358	16 x 2	1/2
B-15	520	250	16 x 2	2/2
B-16	415	390	4 x 2	2/2
B-17	520	466	16 x 1	2/2
B-18	520	466	16 x 1	2/2

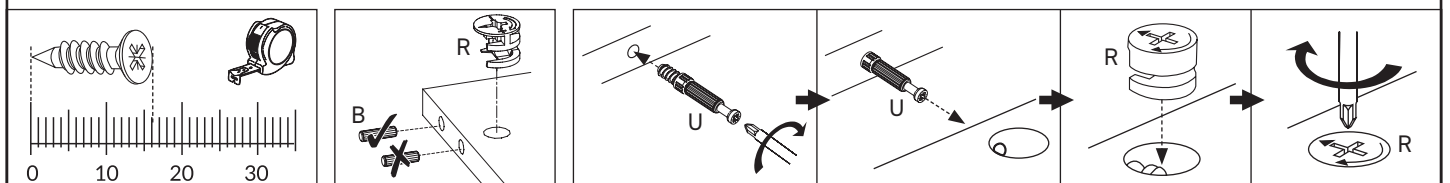

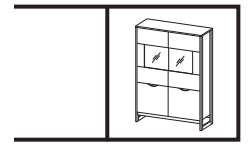

1

2x

B-13

B-15

B3

XG

B3

8 x 50 mm x 8

XG

x 1

Diagram for step 1 shows two panels, B-13 and B-15, being joined. Screws B3 are used to secure the panels together. A circular callout shows glue XG being applied to the joint. A list of parts on the right includes 8 screws B3 (8 x 50 mm) and 1 tube of glue XG.

2

2x

B-15

B-14

XG

x 1

Diagram for step 2 shows panel B-14 being attached to the bottom edge of panel B-15. A circular callout shows glue XG being applied to the joint. A list of parts on the right includes 1 tube of glue XG.

3

2x

HDF

XG

B-13

B-16

B-14

B-15

HDF

358 / 100 mm x 2

XG

x 1

A=B

!

858 mm

!

1h

Diagram for step 3 shows panel B-16 being attached to the front of the assembly. HDF (High Density Fiberboard) is used as a filler between B-16 and B-15. A circular callout shows glue XG being applied to the joint. A list of parts on the right includes 2 pieces of HDF (358 / 100 mm) and 1 tube of glue XG. A diagram on the right shows the assembly with a height of 858 mm and a 1-hour drying time warning. A square diagram indicates that the width of the assembly (A) must equal the height (B).

4

2x

B-3

B

B-2

B

B-4

G2

G2

B

8 x 32 mm x 8

G2

x 4

Diagram for step 4 shows two long panels, B-3 and B-4, being attached to the sides of the assembly. Screws B are used to secure the panels to the front panels. Screws G2 are used to secure the panels to the bottom edge. A list of parts on the right includes 8 screws B (8 x 32 mm) and 4 screws G2.

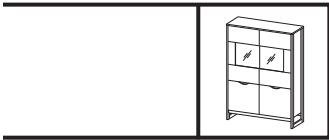

5



T4

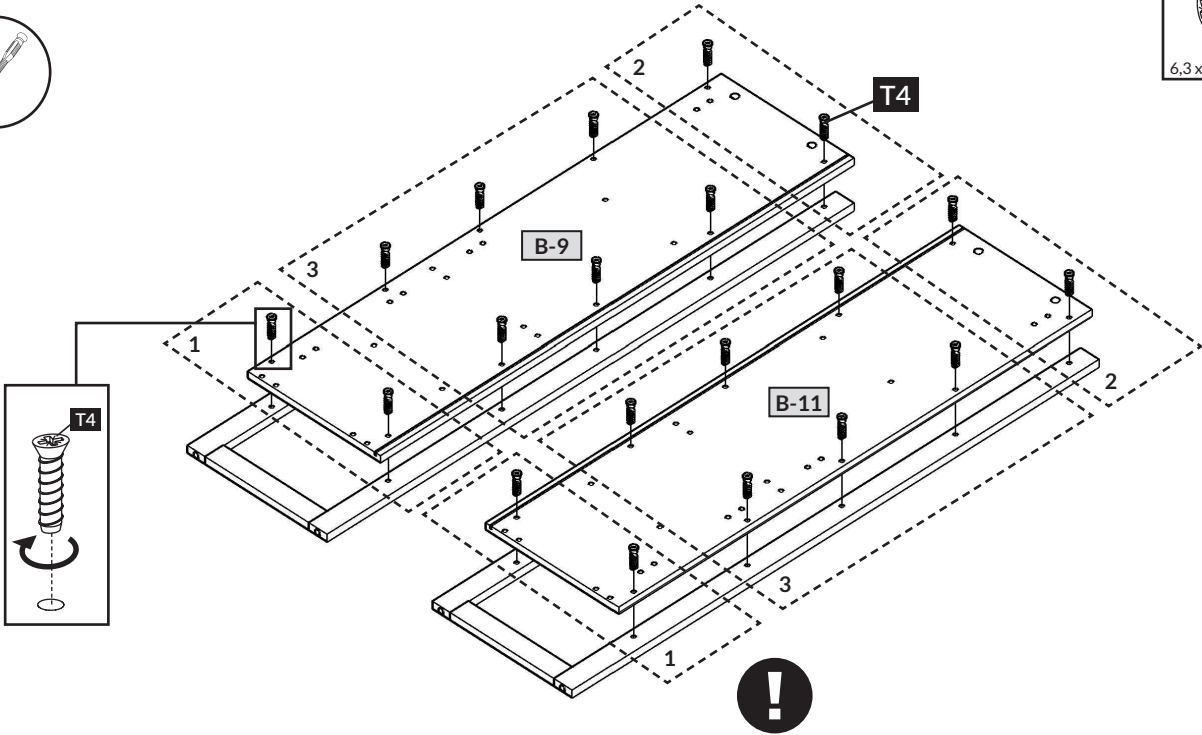
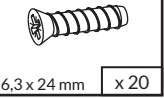

6

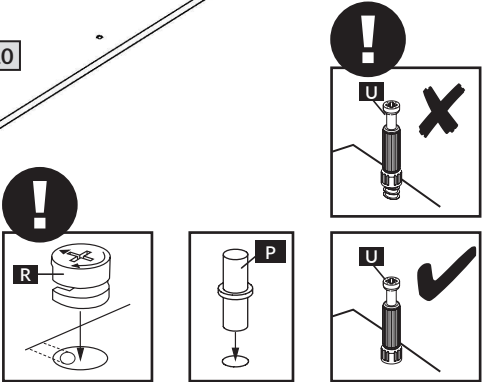
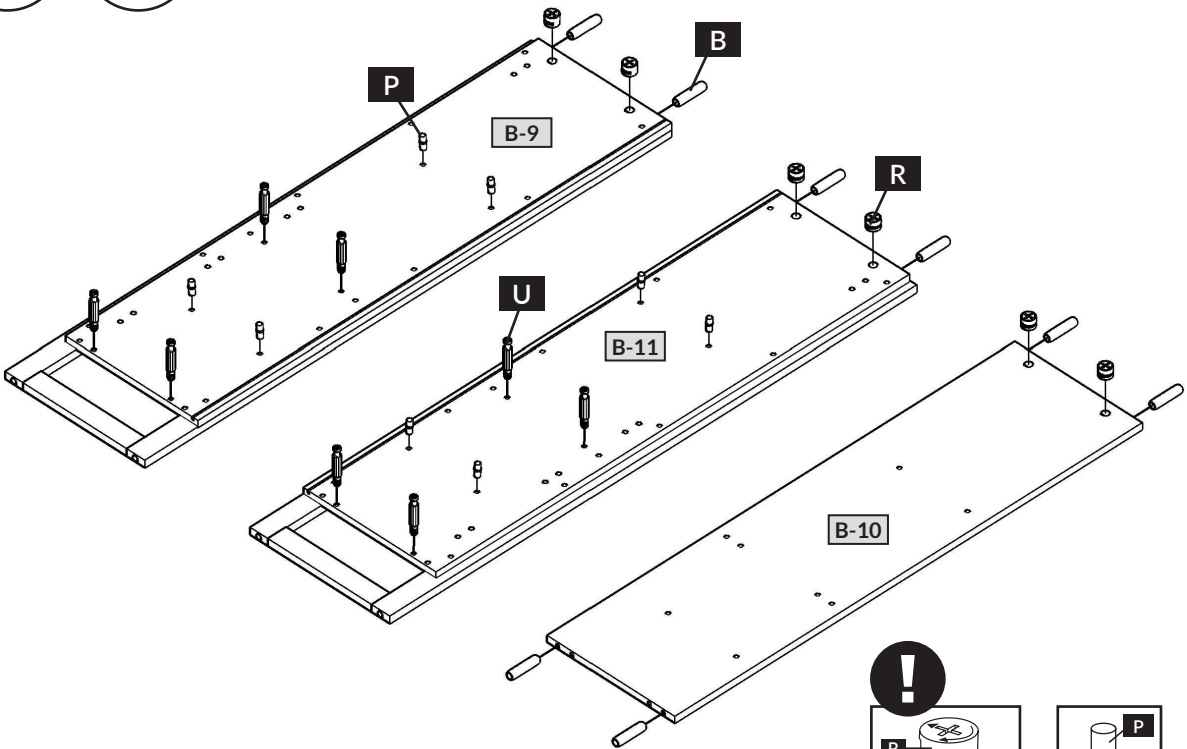
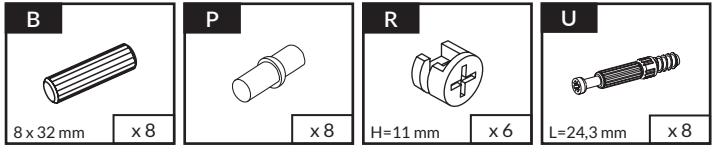
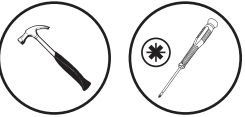

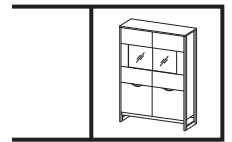

7

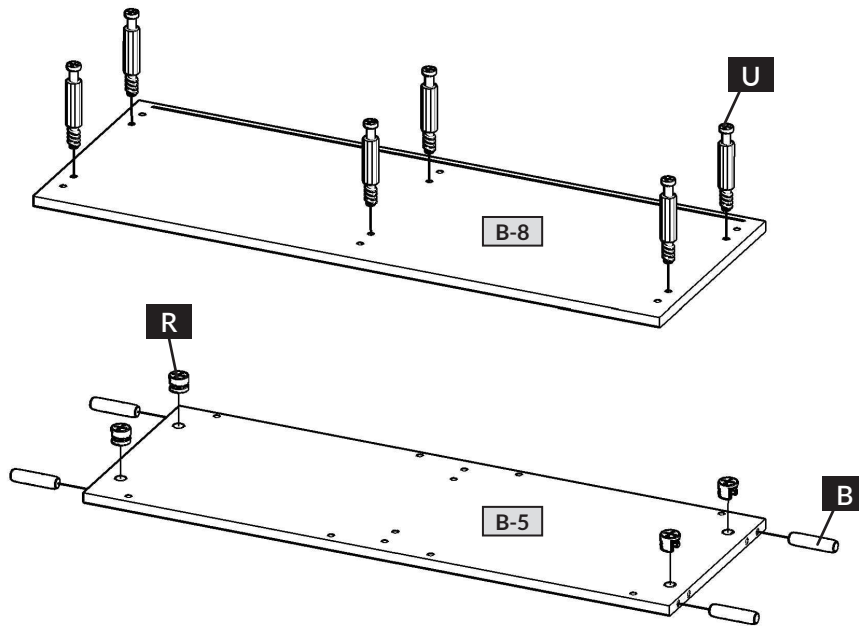

- B**
8 x 32 mm x 4
- R**
H=11 mm x 4
- U**
L=24,3 mm x 6

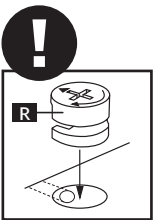

8

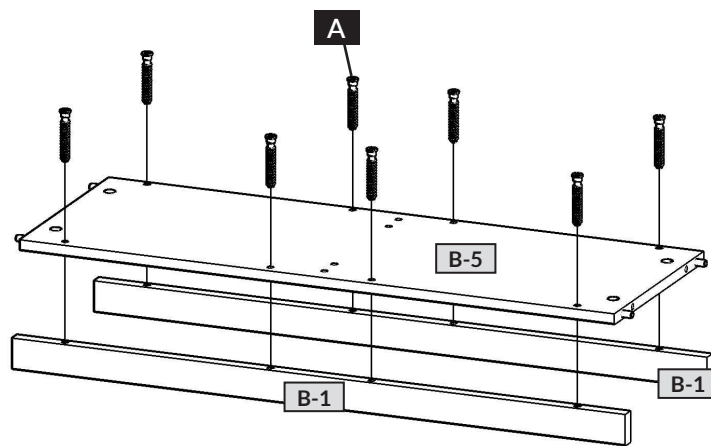
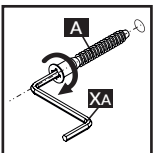

- A**
7 x 50 mm x 8
- XA**
x 1

9

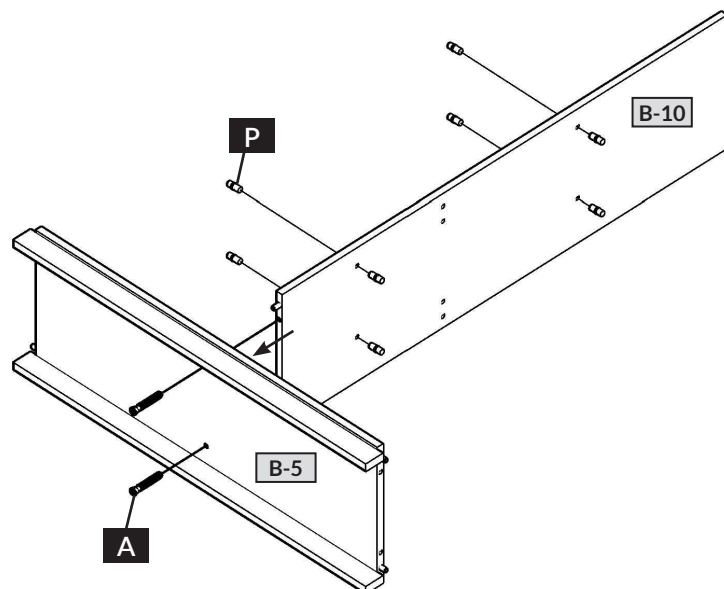
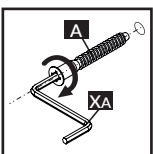
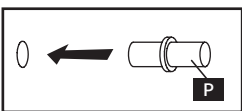

- A**
7 x 50 mm x 2
- P**
x 8
- XA**
x 1

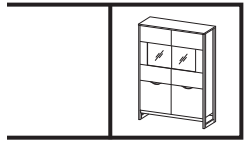

10

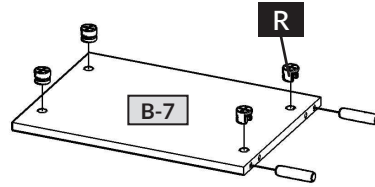
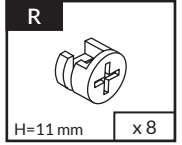
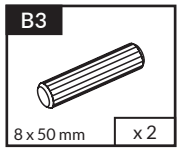
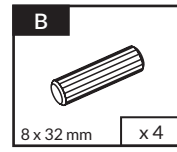
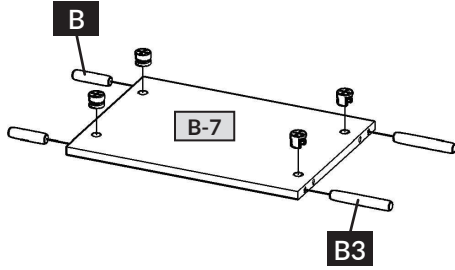
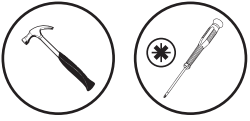

11

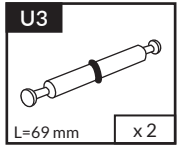
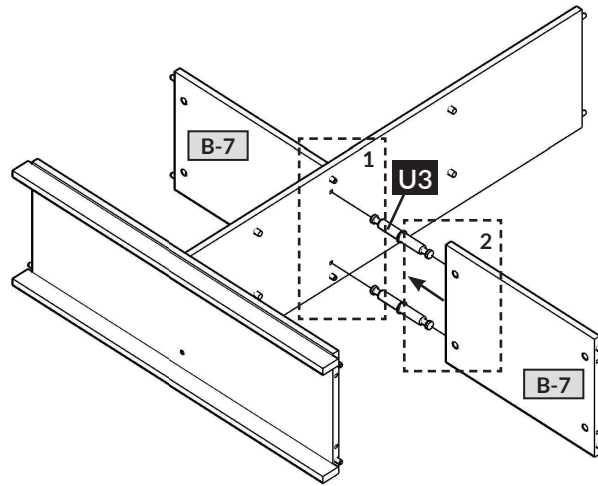

12

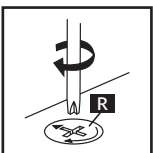
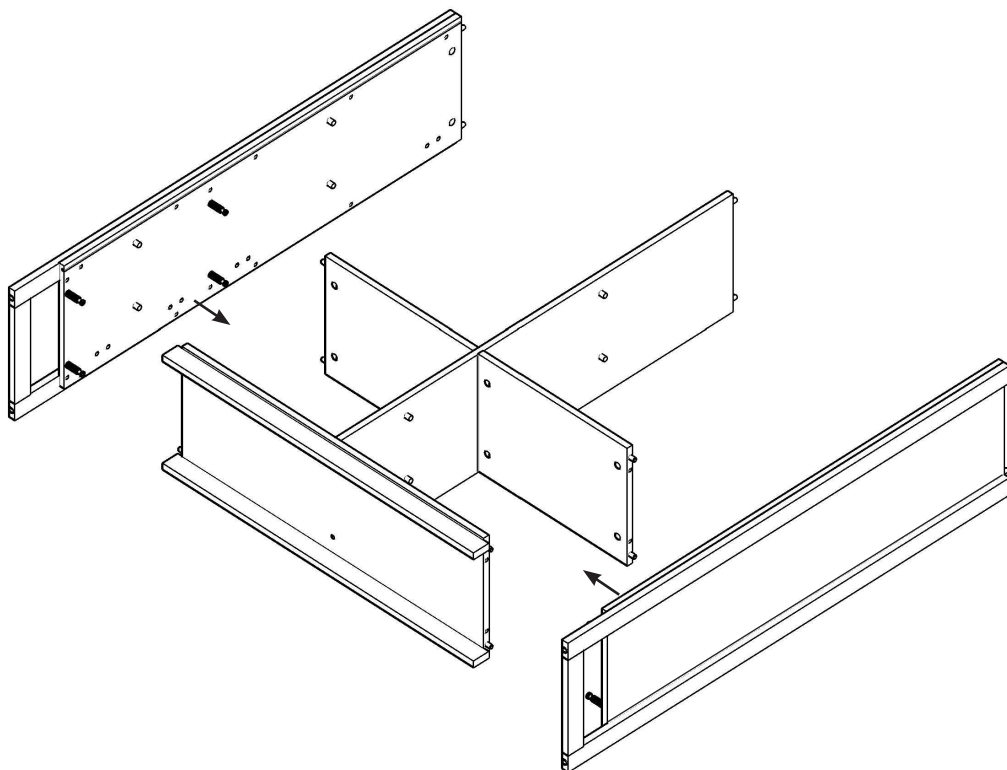

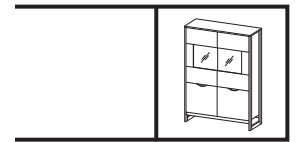

13

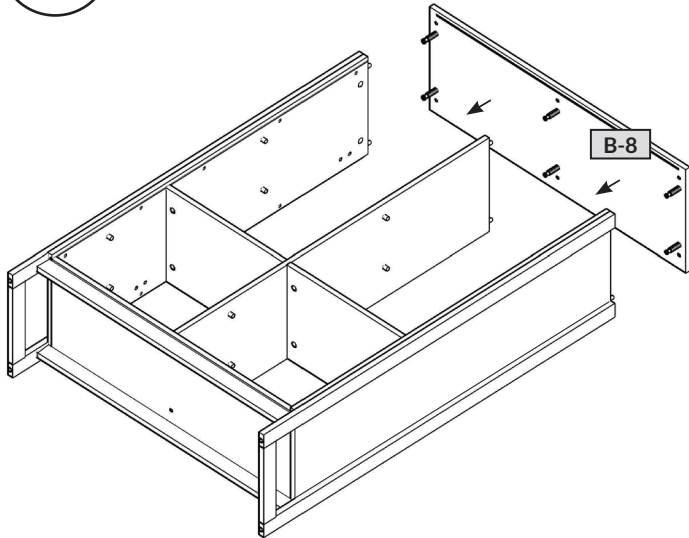

14

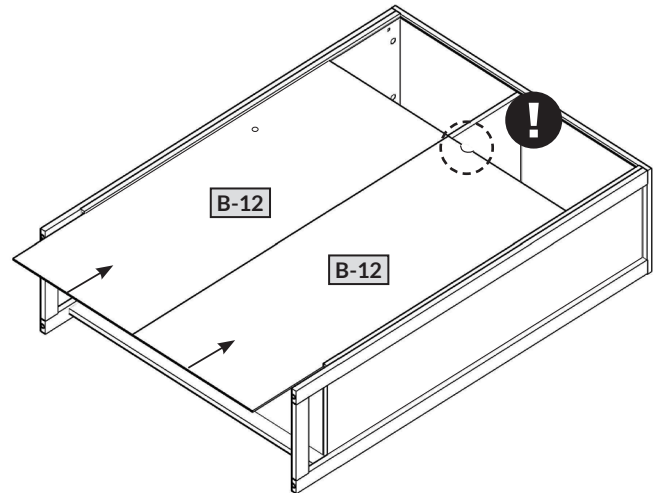

15

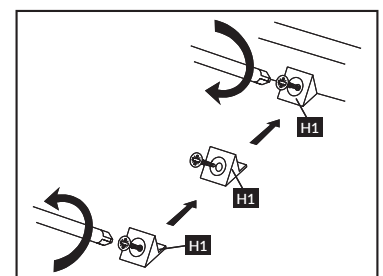
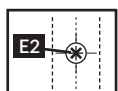
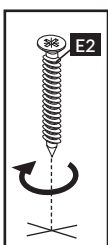
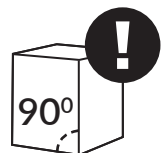
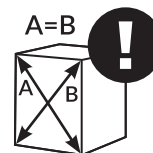
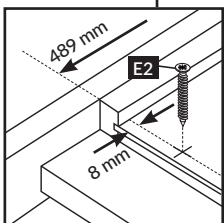
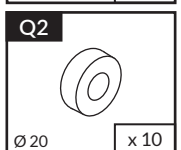
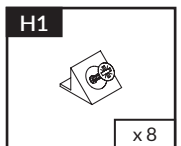
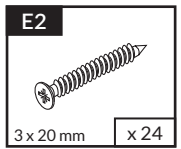
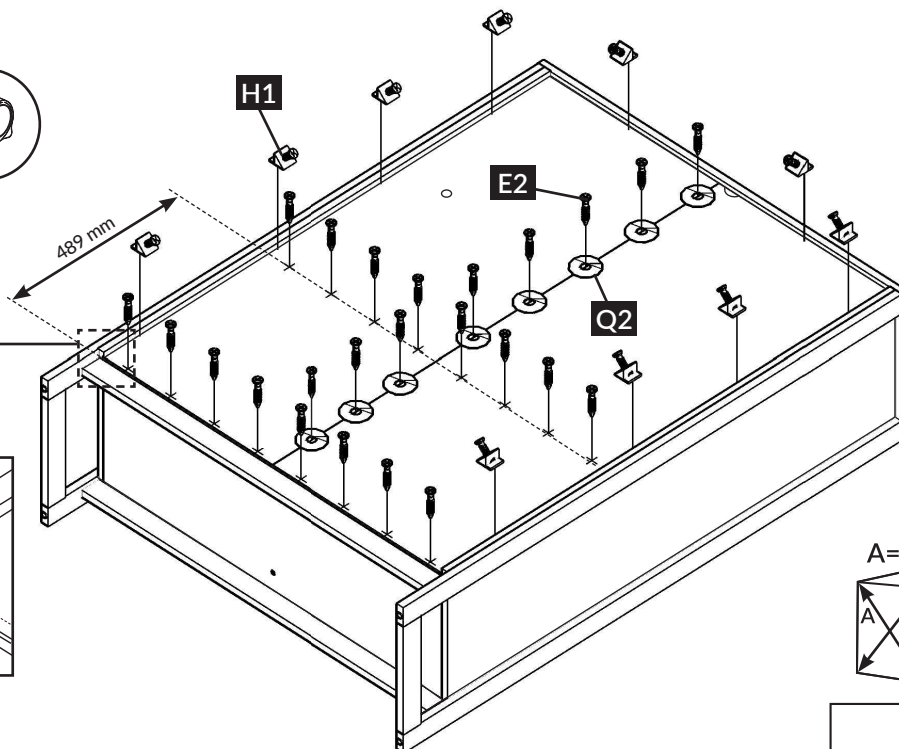

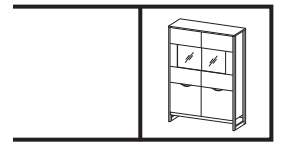

16

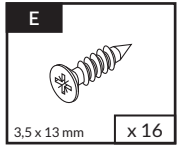
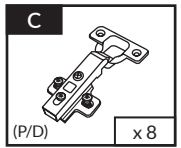
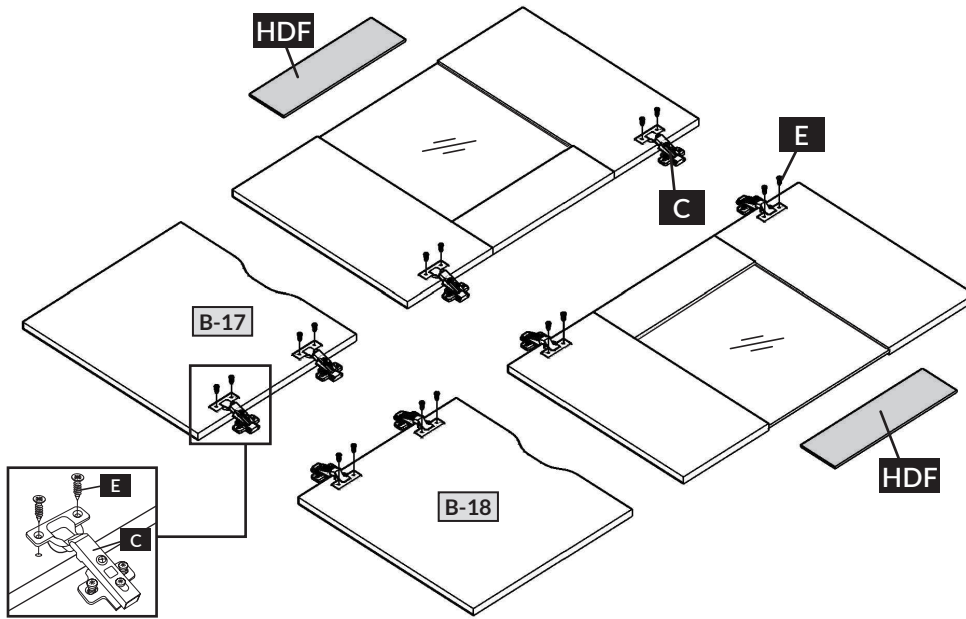

17

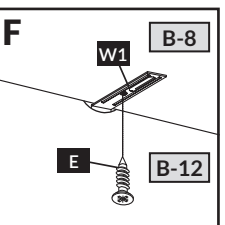
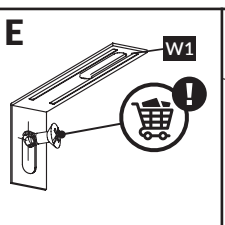
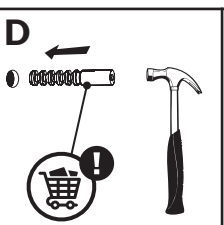
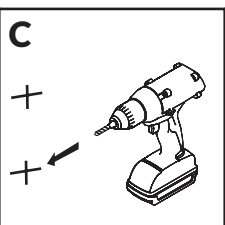
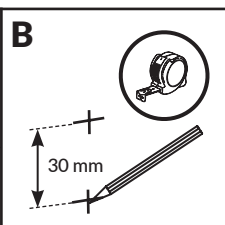
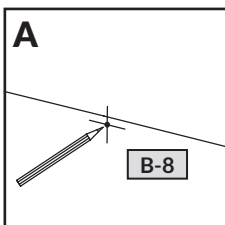
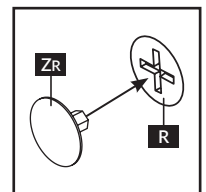
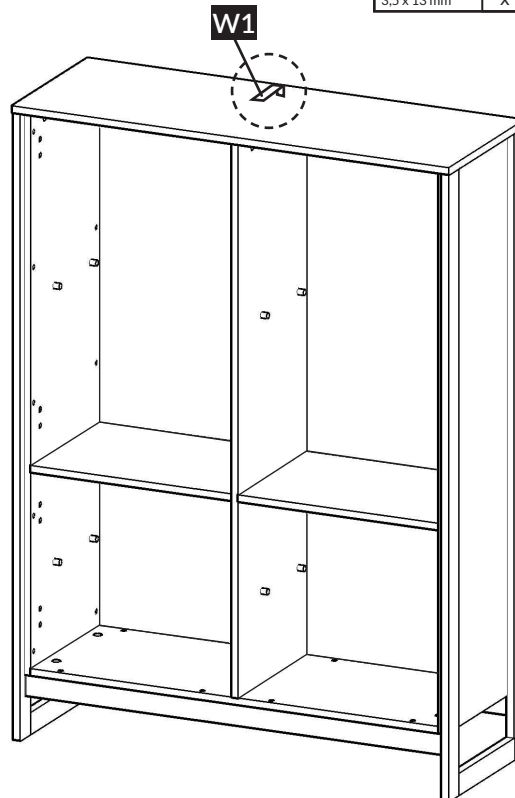
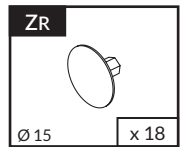
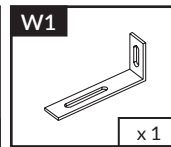
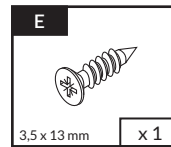
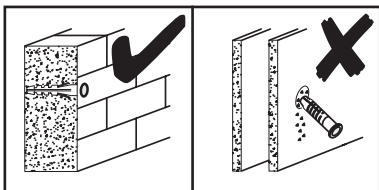
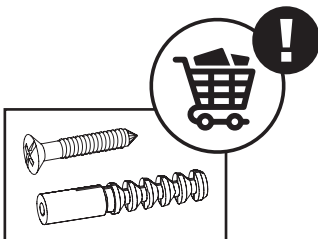
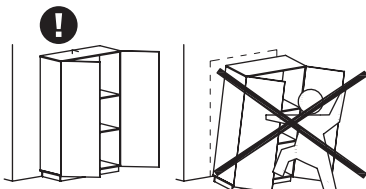
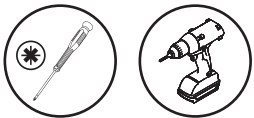
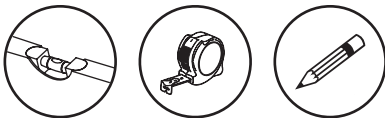

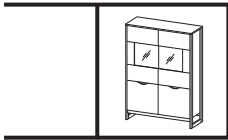

18

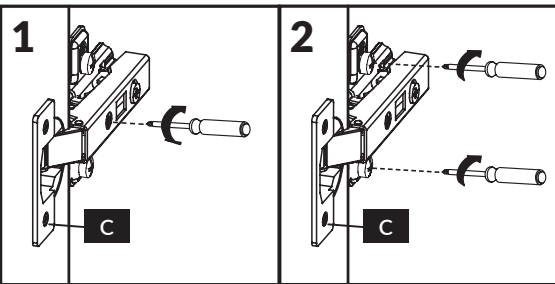
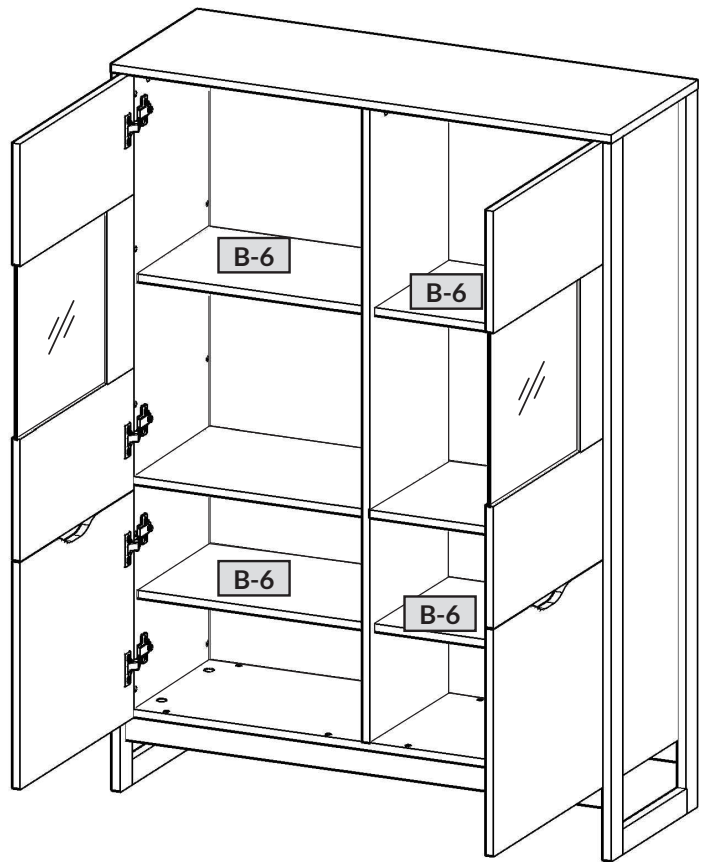

19

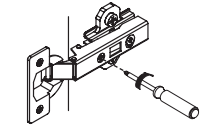
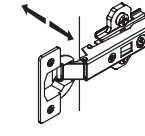
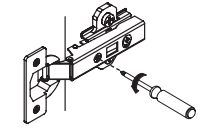
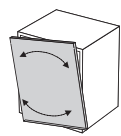
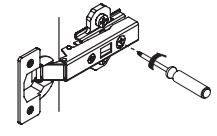
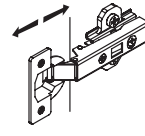
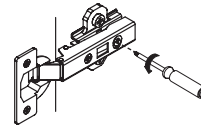
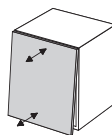
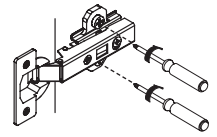
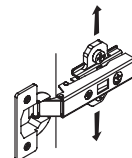
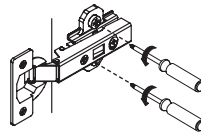
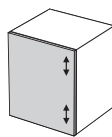
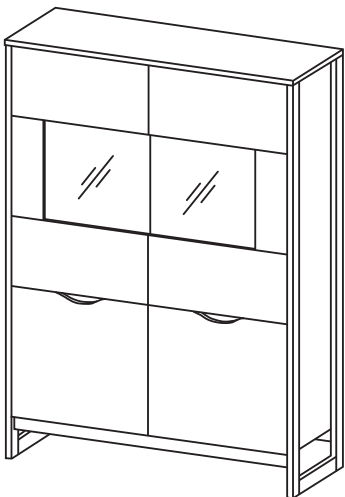

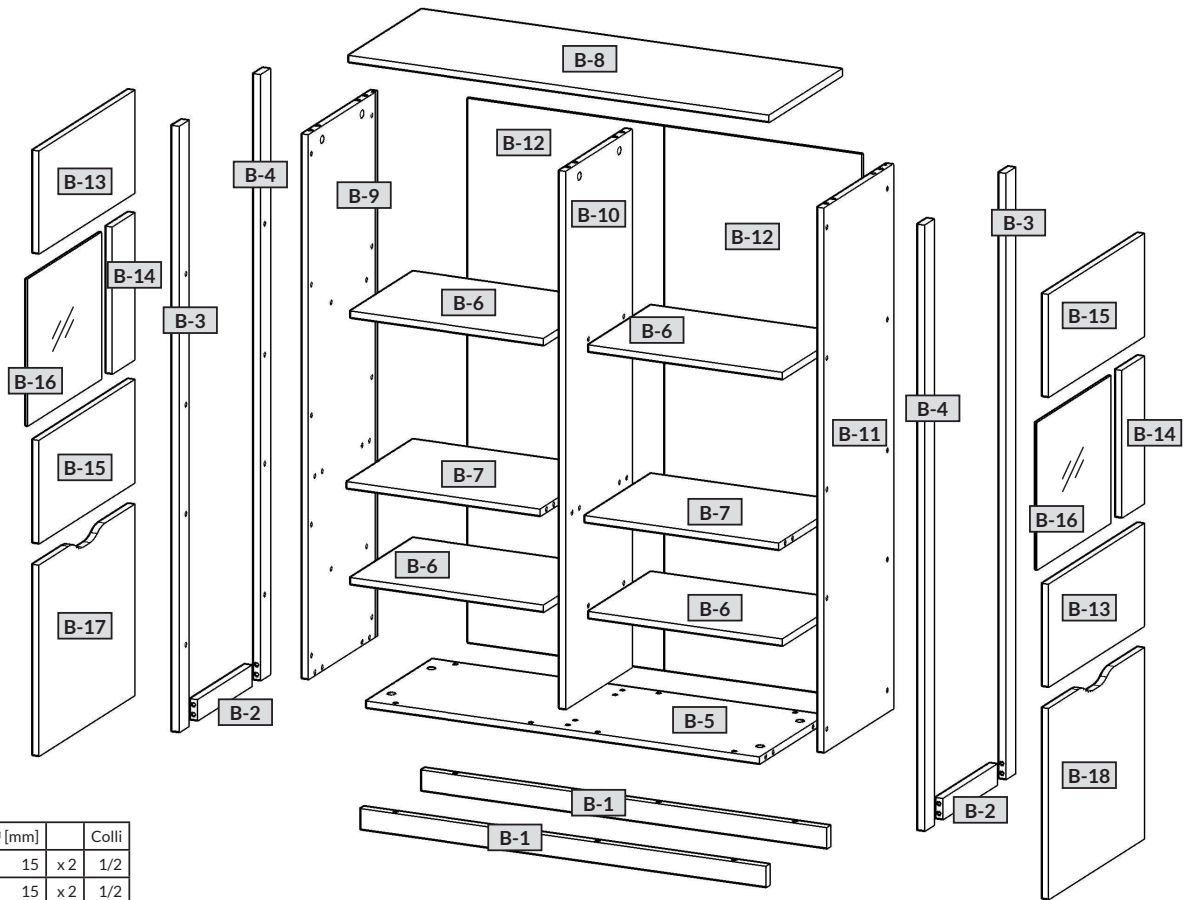
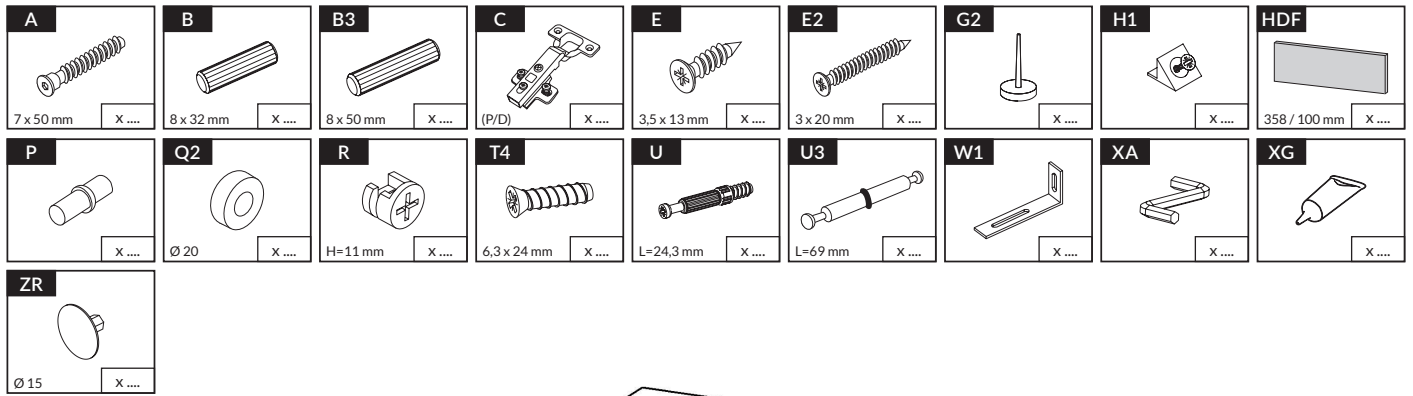
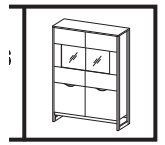

nr	↔ [mm]	↓ [mm]	∅ [mm]		Colli
B-1	1048	50	15	x2	1/2
B-2	294	50	15	x2	1/2
B-3	1480	50	15	x2	1/2
B-4	1480	50	15	x2	1/2
B-5	1016	359	16	x1	1/2
B-6	500	340	16	x4	1/2
B-7	500	359	16	x2	1/2
B-8	1086	396	16	x1	1/2
B-9	1330	374	16	x1	1/2
B-10	1314	359	16	x1	1/2
B-11	1330	374	16	x1	1/2
B-12	1337	515	3	x2	1/2
B-13	520	250	16	x2	2/2
B-14	120	358	16	x2	1/2
B-15	520	250	16	x2	2/2
B-16	415	390	4	x2	2/2
B-17	520	466	16	x1	2/2
B-18	520	466	16	x1	2/2

